



2000

Maximize your production with our #2000 **all-fiber** (airlock) machine, featuring a large 12 inch (30.5cm.) diameter by 16 inch (40.6cm.) long airlock. This unit is one of the highest production machines available in a portable electric model.



MATERIAL PRODUCTION RATE

lbs/hr (kg/hr) rating with 150ft. (45.8m.) of 3" (7.6cm.) hose at 16ft. (4.9m.) elevation

MATERIAL	MACHINE w/shredder & double 3-stage blower lbs/hr(kg/hr)	MACHINE w/shredder & four 3-stage blower lbs/hr(kg/hr)
FIBERGLASS	1000(454)	1300(590)
ROCKWOOL	2000(908)	2000(908)
CELLULOSE	3000(1362)	3000(1362)

Product density and variable blowing conditions will affect production rate. Four blower systems will enable machine to increase range (hose length and elevation) while maintaining production rates.

Note: For Rockwool applications contact Krendl Machine Company for upgrade kit.

FEATURES AND BENEFITS

WEIGHT

610 lbs. (277 kg.)

DIMENSIONS

55"W x 25"D x 46 1/2"H
(140cm. W x 63cm. D x 118cm. H)

HOPPER CAPACITY

16 cu. ft. (.44 m³)
33 cu. ft. (.92 m³) w/Extension

AIRLOCK

16" x 12" diameter (40.6cm. x 30.5cm. diameter)
3" (7.6cm.) outlet for blowing hose

POWER REQUIREMENT

single input,30amp/240volt/60hz
double input,20amp and 30amp/120volt/60hz
(consult factory for hook-up)
(230volt/50hz available for export)

BLOWERS/SIZES

12.5 amp/3-stage (120volt)

CE MARK CONFORMITY

See reverse side for more information.

Mechanical

- Modular component design for quick disassembly/reassembly for easy troubleshooting and maintenance
- Safety guards and hopper bars provide operator safety
- Flip-top hopper 16 cu. ft. (.44m³) for quick and easy access to airlock
- Four (4) stainless steel agitators enhance the conditioning of fibers with no corrosion
- All steel airlock for enhanced spraying and metering capabilities
- Shredder assembly increases production and material conditioning and provides consistent material flow
- 2 hp. direct drive Totally Enclosed Fan Cooled motor/reducer (1260 in./lb. torque) for long life
- Heavy, nickel-plated #50 chain with hardened steel sprockets provides a corrosion/abrasion resistance drive system
- Check valve protection and filter design w/ 4" (10.2 cm.) outside fresh air inlet provide increased blower efficiency and durability/ less filter maintenance/and better protection of blower
- Multiple blower capability and single material output for increased range and back-up blower capability
- Cord hanger and hand pendant allow for convenient storage of cords and hand pendant

Electrical

- Operator safety/Hazard response features: pre-alarm buzzer, main disconnect/ power interruption shutdown, emergency kill switch, manual override at machine
- 150 ft. (46m.) remote control cord with 3 position switch give increased operator control of feed and blower
- Overload protection on transformer and all motors providing complete protection of all electrical components
- Deluxe voltmeter is an indicator for low/high voltage protection of motors
- Multiple auxiliary convenience outlets for easy addition of accessory devices (i.e. wetting, wireless, pump systems)

SPECIFICATIONS

BLOWER	AIRLOCK PRESSURE (P.S.I.)	BLOWER RATING (C.F.M)	BLOWER AMPERAGE	AGITATOR AMPERAGE
DOUBLE 3-STAGE	4	94 (x 2)	12.5(x2)	20
FOUR 3-STAGE	4 1/2	94 (x 4)	12.5(x4)	10

When figuring rates for 230volt/50hz, divide amperage ratings by half.

AVAILABLE (See diagram at right)

- bushing reducer - 3" to 2" (Part # 109074)
or bushing reducer 3" to 2 1/2" (Part # 109075)
- 5" (12.7 cm.) standard duty wheel package (Part # W-5-STD)
or heavy duty locking wheel package (Part # W-5-HD)
- hopper extension - 44"W x 20"D x 32"H
(112cm. W x 51cm. D x 81.3cm. H)
(Part # US-1000/2000)
- two 12.5 amp/3-stage blowers
- four 12.5 amp/3-stage blowers
- 230volt/50hz (for export) **CE** Mark Conformity

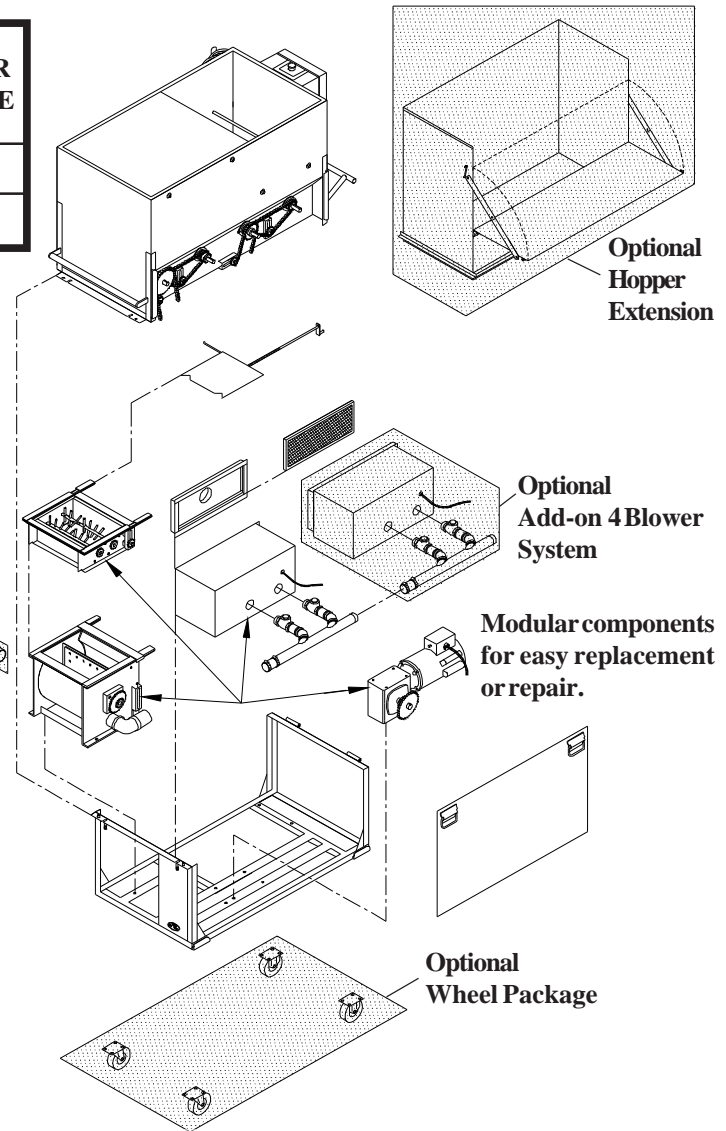

ALL-FIBER MACHINE - THEORY OF OPERATION

(See diagram at right)

This unit is designed to accept all fiber materials into the hopper area of the machine, passing through a multi-step agitation system and dropping into the rotating airlock feeder. The airlock feeder has a crankgate control providing precision feeding of fiber for open blowing, sidewall blowing, and spray-on applications. Fiber is then rotated to bottom of airlock where air from the blower motor pushes fiber from the rotating chambers through the hose. Material and air is prevented from escaping into the machine while in the airlock by six rubber seals which conform to the airlock inner wall as the chambers revolve. The blower motors (double 3-stage, 12.5 amp) is a high speed unit with low amperage designed to blow air. (Fiber **does not** pass through the blower fan chamber.) The high pressure and adjustable volume provides low amperage, low noise, and minimal attic dust. This reduces hose plugging problems and gives longer blower life.

Note: All-fiber/airlock machines provide slightly less coverage than thru-blower machines. Airlock machines cannot duplicate the high speed (13,000 r.p.m.) conditioning effect of fiber passing through the blower. Airlock machines blow the fiber closer to settled density which eliminates the need for overblowing material to compensate for progressive settling.

